

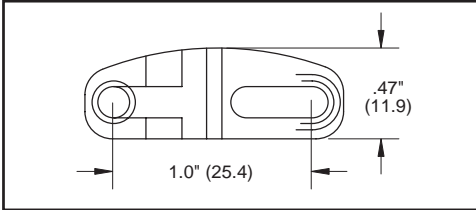

All-in-One Curved Top (CT61000)

- 1 inch pitch
- Turning radius equals 2.2 times the nominal belt width up to 24". Turning radius equals 2.5 times the nominal belt width over 24".
- Curve top surface for constant contact scraper
- 72% open area with reduced product contact
- Built to USDA & FDA standards
- Bi-directional
- Connecting rod diameter = 5/32 inch
- Standard belt width increments = 3 inch (76.2) nominal, starting from 6 inches (152.4). Non-standard widths available in 1/2 inch increments upon request.
- Material selection may affect belt width - please consult factory for actual dimensions

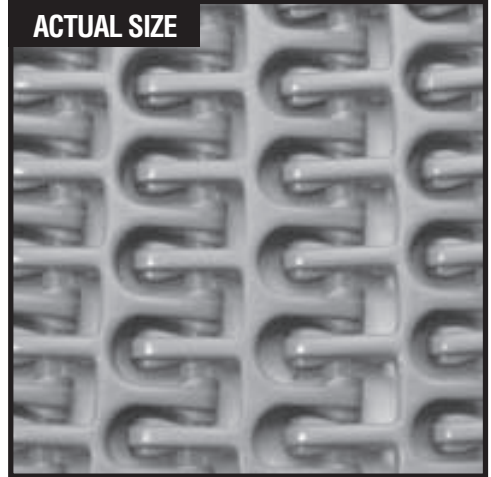

Certified dimensions of ordered material furnished upon request.

BELT DATA

Belt Material	Color	Standard Rod Material	Maximum Belt Pull		Belt Weight		Continuous Temp. Range		Agency Standards	
			LBS	N	LB/FT ²	kg/m ²	F°	C°	FDA	USDA meat/poultry
Propylene	gray	Nylon	180	800	.81	3.95	+50 to +210	+10 to +99	✓	✓
Ethylene	white	Acetal	100	445	.87	4.25	-100 to +60	-73 to +16	✓	✓
Acetal	off-white	Nylon	300	1,334	1.0	4.88	-40 to +200	-40 to +93	✓	✓
Nylon 2	gray	Nylon	300	1,334	1.25	6.1	-40 to +245	-40 to +118	✓	✓
High Temp Nylon 3	brown	High Temp Nylon 3	300	1,334	1.28	6.25	-40 to +385	-40 to +196	✓	✓

Additional belt colors available, please consult factory. Consult factory for material recommendations for higher intermittent temperatures. Please refer to Engineering Data for the effect of operational conditions on belt pull.

BELT ACCESSORIES

High Friction Rubber Insert	Standard Flights	Pop-up Flights
<p>Curved</p> <p>Raised Rib</p>		<p>Up Position</p> <p>Down Position</p>

Note: High friction inserts may affect belt pull - please consult factory.

Standard flights are available in standard 1" and 2" heights. Standard flight indent is 1" or 3" from outside edge of belt.

Note: Pop-up flights increase turning radius. Please consult factory.

Sprocket Information

Sprocket Information

1" Pitch All-in-One IS, CT, RR & RT (IS61000, CT61000, RR61000 & RT61000)



Molded Sprocket

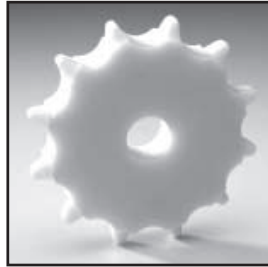

Machined Sprocket

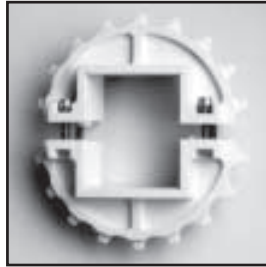

Molded Split Sprocket

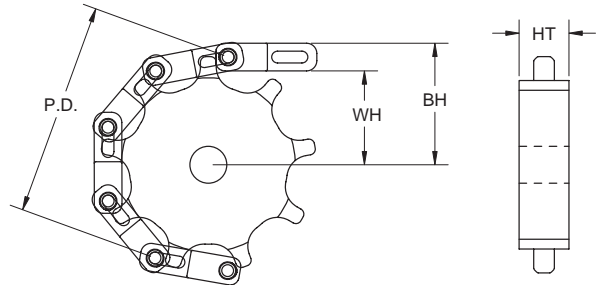

Split Sprockets and other sizes are available - consult factory for non-standard sizes

Sprocket Part Number	No. of Teeth	(PD) Nominal Pitch Diameter		(WH) Shaft Center to Top of Wearstrip		All-in-One (BH) Shaft Center to Top of Belt		Curved Top (BH) Shaft Center to Top of Belt Curve		Rugged Rib Top (BH) Shaft Center to Top of Belt Rib		Rugged Texture Top (BH) Shaft Center to Top of Belt Texture		(HT) HUB Thickness	
		in.	mm	in.	mm	in.	mm	in.	mm	in.	mm	in.	mm	in.	mm
71007M*	7	2.31	59	0.97	25	1.34	34	1.43	36	1.6	41	1.36	35	1.5	38
71009M*	9	2.92	74	1.27	32	1.65	42	1.74	44	1.91	48	1.67	42	1.5	38
71012M	12	3.87	98	1.75	44	2.12	54	2.21	56	2.38	60	2.14	54	1.5	38
71015M	15	4.81	122	2.22	56	2.59	66	2.68	68	2.85	72	2.61	66	1.5	38
71018MS	18	5.80	147	2.71	69	3.085	78	3.175	81	3.345	85	3.11	79	1.5	38
SP71019	19	6.08	162	2.85	72	3.23	82	3.32	84	3.64	92	3.25	83	0.68	17
SP71030	30	9.54	242	4.58	116	4.955	126	5.045	128	5.215	132	4.98	126	0.68	17

M = Molded Sprocket MS = Molded Split Sprocket *Cannot be used with belts with Hold Down Tabs - 9 Tooth works with 1" and 1.24" round bores.

Sprocket Part Number	Available Bore Size															
	25 mm	1"	1" sq.	30 mm	1-1/4"	1-7/16"	1-1/2"	1-1/2" sq.	40 mm	40 mm sq.	1-15/16"	50 mm	2"	60 mm	60 mm sq.	2-1/2" sq.
71007M*	✓	✓	✓	✓	-	-	-	-	-	-	-	-	-	-	-	-
71009M*	✓	✓	✓	✓	-	✓	✓	-	-	-	-	-	-	-	-	-
71012M	✓	✓	✓	✓	-	✓	✓	-	-	-	✓	-	✓	-	-	-
71015M	-	✓	-	✓	✓	✓	✓	✓	✓	-	✓	-	✓	-	-	-
71018MS	-	-	-	-	-	-	-	✓	-	-	-	-	-	-	-	✓
SP71019	✓	✓	✓	✓	✓	✓	✓	✓	✓	✓	✓	✓	✓	✓	✓	✓
SP71030	✓	✓	✓	✓	✓	✓	✓	✓	✓	✓	✓	✓	✓	✓	✓	✓

M = Molded Sprocket MS = Molded Split Sprocket. All bores are round unless designated square (sq.). *Cannot be used with belts with Hold Down Tabs - 9 Tooth works with 1" and 1.24" round bores.

For Keyway Dimensions refer to KVP Engineering Guidelines, Pg. 40, Table 13.

Radius 1" Pitch Belting